

WELCOME TO



# sono Pod

# IMPORTANT INFORMATION

## Charging the Cuattro Hub Components

The Cuattro Hub™ family of products is designed to share one power adapter.

Power the Cuattro Hub, Sono Pod™ battery cradle, 1013 Detector Battery Cradle with the Cuattro Hub Power Brick.

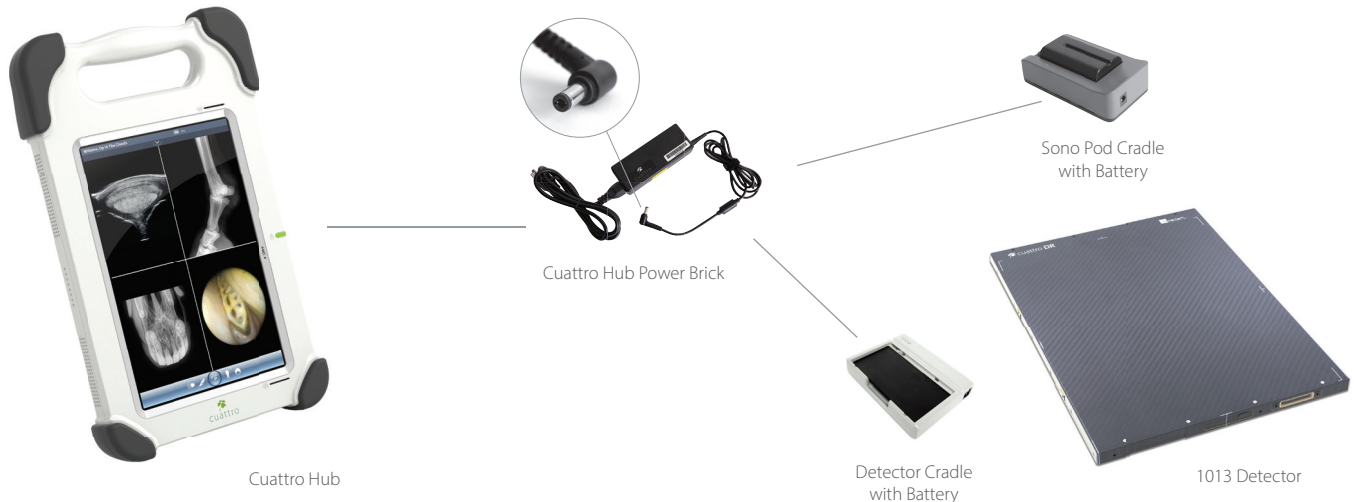

Charge the Sono Pod using the Main Adaptor included with the Sono Pod.\*

\*The Sono Pod **can not** be used while being charged with the Main Adaptor.



## Recharging the Battery in the Battery Cradle

Plug the Cuattro Hub power supply into the Sono Pod battery cradle. Snap the Sono Pod battery into the cradle.

The battery is fully charged when the LED light changes from **red** to **green**.

The Sono Pod comes with two (2) batteries, one (1) inside the probe battery compartment and one (1) spare.